



**FOR SALE**  
\$280,000

# RM H23-MEDIUM RISE MULTIFAMILY LAND

11833 Fort Road, Edmonton, AB | Lot 10&11, Block 7, Plan 2436AB

### Property Description

The property is zoned RM H23 for medium-rise multi-unit housing, offering an excellent location with high visibility on the main Fort Road. It is situated directly across from the established Parkdale Square commercial plaza, providing great exposure.

The site consists of two vacant lots totaling 6,453 square feet, and it is fully serviced, allowing for a wide range of permitted uses.

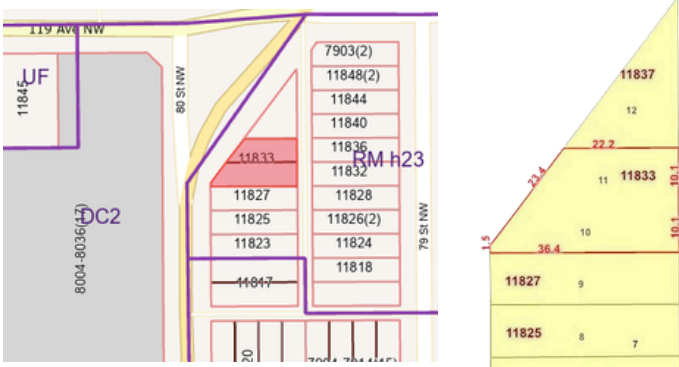

**JUDITH RIMMER**, Vice President  
 ☎ (780) 405.9333 ✉ [jrimmer@remaxexcellence.com](mailto:jrimmer@remaxexcellence.com)

**REMAX Excellence** **REMAX COMMERCIAL**

This brochure is for general informational purposes only. No warranty is made regarding the accuracy of the information, which is subject to errors, omissions, price changes, and withdrawal without notice. The information contained herein was obtained from sources deemed to be reliable and is believed to be true; it has not been verified, and as such, cannot be warranted nor form a part of any future contract. All measurements should be independently verified by the Purchaser/Tenant. REMAX Excellence independently owned and operated, and shall not be held liable for any loss and damages arising from information provided in this brochure. Stats are subject to change; please call for more information. 201, 5607 - 199 Street, Edmonton, AB T6M 0M8